

SECTION A-A

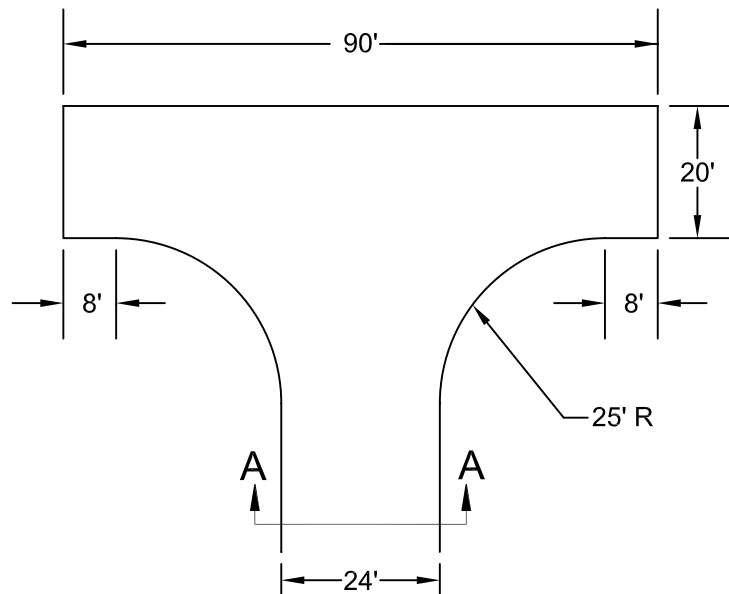

NOTES:

1. Access width can be narrowed to 20 feet with the approval of the Fire Marshal and City Engineer.
2. Curb height is not to exceed 6-inches.
3. "NO PARKING" area is to be defined by yellow curb.
4. "NO PARKING / FIRE LANE / TOW ZONE" sign locations to be determined by the Fire Marshal and City Engineer.
5. Drainage is required to prevent ponding.
6. Area of turnaround is to be permanently maintained, cleared and unobstructed at all times.
7. Adjacent landscape is to be approved by *City of Beaverton Board of Design Review*.
8. Use of this turnaround at any specific site must be approved by the Fire Marshal and City Engineer.



City Of Beaverton

**PUBLIC WORKS
DEPARTMENT**

INTERIM TURNAROUND

CITY ENGINEER
Terry Waldele, P.E.

DATE
6 - 10 - 04

DRAWN BY
NPR - TSD

DRAWING NO.
120