

**CITY TRAFFIC ENGINEER'S REPORT
ISSUE NO. TC 757**

Parking Restrictions on SW Osprey Drive North of Teal Boulevard

April 17, 2017

Background Information

Ms. Adeana Johnsen, Beaverton Resident requested the restriction of parking on the west side of SW Osprey Drive north of Teal Boulevard along the back of the homes facing Heron Court (see attached map). Ms. Johnsen indicated that transients are sleeping in their vehicles on Osprey Drive near her home. She is concerned about the livability of the neighborhood and the safety of her family.

Currently parking is allowed only on one side of Osprey Drive. Transportation staff visited the site and observed the parking activity during different times of the day. It was observed that the demand for parking is very high especially at night where almost all available parking spaces are occupied except near the intersection with Teal Boulevard. Staff did not observe any indication that individuals are living in their vehicles.

Restricting parking on SW Osprey Drive north of Teal Boulevard would have a high impact on residents in the area. Staff is proposing to deny the request to restrict parking on Osprey Drive.

Applicable Criteria

Applicable criteria from Beaverton Code 6.02.060A are:

- 1d (accommodate the parking needs of residents and businesses in a safe and equitable fashion).

Conclusions:

1. The demand for on-street parking on SW Osprey Drive is very high. Restrict parking on SW Osprey Drive north of Teal Boulevard will have an adverse impact on residents in the area. Therefore Criterion 1d is not met.

Recommendation:

1. Deny the request to restrict parking on the west side of SW Osprey Drive north of Teal Boulevard.

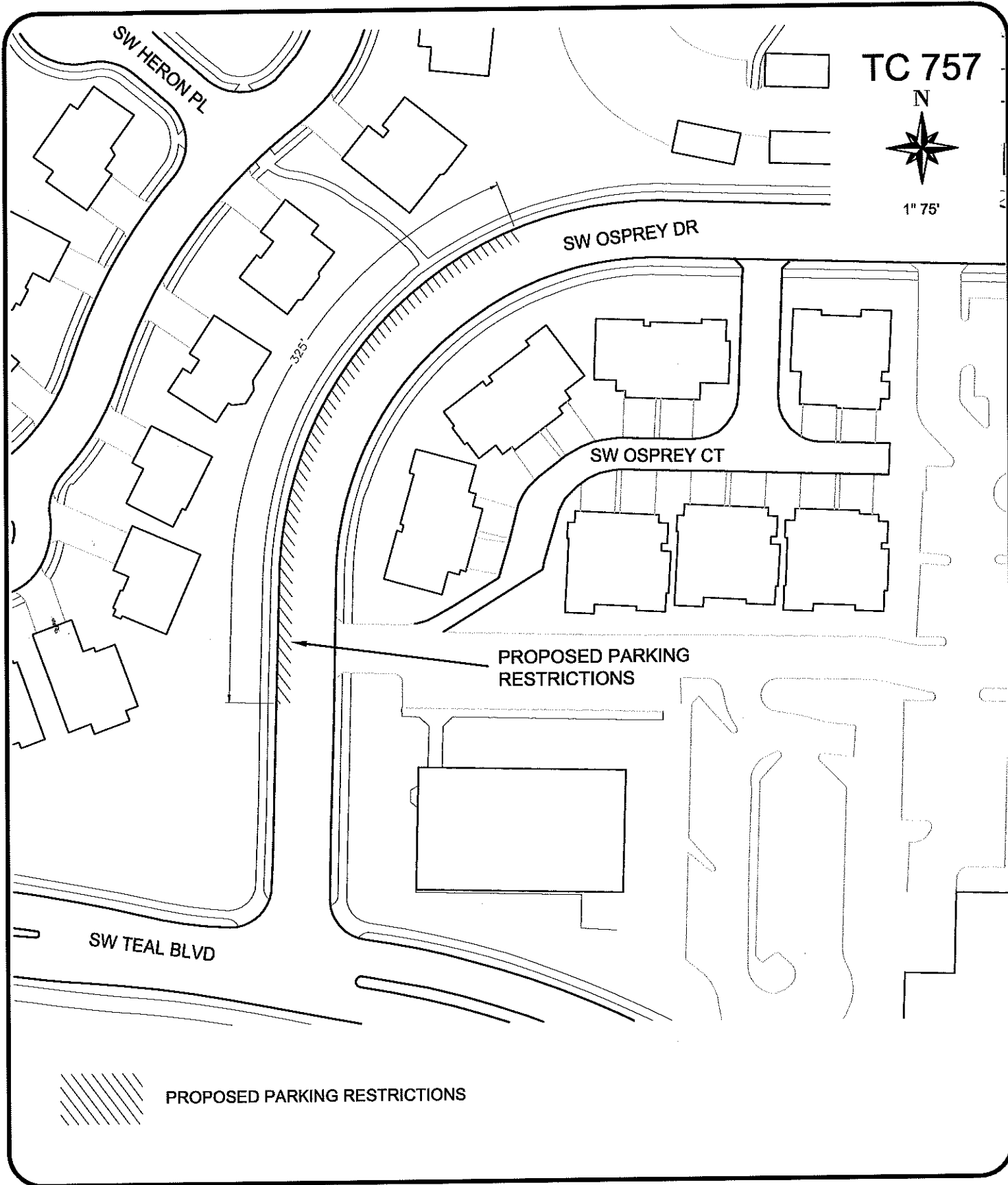

Y:\TRANSPORTATION\Drawings\2017\2017-15 - Parking Restrictions On SW Osprey Dr North Of Teal Blvd (TC 757)_BASE 17.dwg



PARKING RESTRICTIONS ON
SW OSPREY DR NORTH OF TEAL BLVD

PUBLIC WORKS DEPARTMENT
TRANSPORTATION SECTION

Drawn By: AL Date: 4-17-17

Reviewed By: _____ Date: _____

Approved By: _____ Date: _____

MEMORANDUM

Beaverton Police Department



DATE: April 24, 2017

TO: Jabra Khasho, City Transportation Engineer

FROM: Sergeant Steve Schaer

SUBJECT: Traffic Commission Issues No. TC 757

On review of the City Traffic Engineer's report, and my visitation of the location, I concur with the Traffic Engineer's recommendation to deny the request to restrict parking on the west side of SW Osprey Drive north of Teal Boulevard.

Thank you,

Sgt Steve Schaer