

**CITY TRAFFIC ENGINEER'S REPORT
ISSUE NO. TC 782**

**Overnight Truck Parking Restrictions on NW 167th Place, NW Twin Oaks Drive and
SW Merlo Drive**

September 17, 2018

Background Information

Officer Mark Barrowcliff of the Beaverton Police Department requested restricting overnight truck parking on NW 167th Place south of Cornell Road, on NW Twin Oaks between Cornell Road and 167th Place and on SW Menlo Drive between Menlo Road and 170th Avenue (see attached memo). Officer Barrowcliff indicated that since the City adopted the No Camping ordinance throughout the city, those streets are being used for truck parking and storage by individuals that are not connected to any of the businesses in the area. He indicated that when trucks are parked on the side of the street it creates a safety hazard to the community.

The pavement width of NW 167th Place and NW Twin Oaks is 40 feet. Both streets are classified as Local Streets that serves office and industrial businesses. Although the area around these streets was planned for office industrial use, in the last several years many of the buildings in the area is occupied by new businesses that provide general services.

The pavement width of SW Merlo Drive is 44 feet. It is classified as a Local Street that serves Merlo High School and office and industrial businesses. Due to the growth in the area and the construction of several multifamily developments on 170th Avenue, the pedestrian and bike activity on Merlo Drive has increased by individuals getting to the school and to the Merlo Max station.

During field visits to the sites, staff observed that the demand for on-street parking from businesses along NW 167th Place, NW Twin Oaks and SW Merlo Drive is very low as businesses have large parking lots with ample parking. It was also observed that the streets are used for truck storage with trucks lined on both sides of the street that makes it difficult for drivers to see pedestrians walking or crossing the street. Many of the trucks did not move for several days.

The demand for overnight truck parking by the businesses along NW 167th Place, NW Twin Oaks and SW Merlo Drive is very low. This was also confirmed in the attached memo from Officer Barrocliff.

Staff is proposing to restrict overnight truck parking on NW 167th Place south of Cornell Road, on NW Twin Oaks between Cornell Road and 167th Place and on SW Merlo Drive between Merlo Road and 170th Avenue.

Applicable Criteria

The applicable criterion from Beaverton Code 6.02.060A is:

- 1a (provide for safe vehicle, bicycle and pedestrian movements);
- 1g (carry anticipated traffic volume safely);
- 1d (accommodate the parking needs of residents and businesses in a safe and equitable fashion).

Conclusions:

1. Restricting overnight truck parking on NW 167th place, on NW Twin Oaks and on SW Merlo Drive would discourage truck storage on the street that would improve the visibility and the safety of pedestrians, bicyclists and vehicles using the street, satisfying Criteria 1a and 1g.
2. The demand for on-street overnight truck parking by businesses along NW 167th Place, NW twin Oaks and SW Merlo Drive is very low. Restricting overnight truck parking would not affect the parking needs for those businesses, satisfying Criterion 1d.

Recommendation:

1. Restrict overnight truck parking on NW 167th Place south of Cornell Road, on NW Twin Oaks between Cornell Road and 167th Place and on SW Merlo Drive between Merlo Road and 170th Avenue.

TC # 782



1" = 200'

**PROPOSED OVERNIGHT TRUCK
PARKING RESTRICTIONS**

**PROPOSED OVERNIGHT TRUCK
PARKING RESTRICTIONS**

 PROPOSED OVERNIGHT TRUCK PARKING RESTRICTIONS.

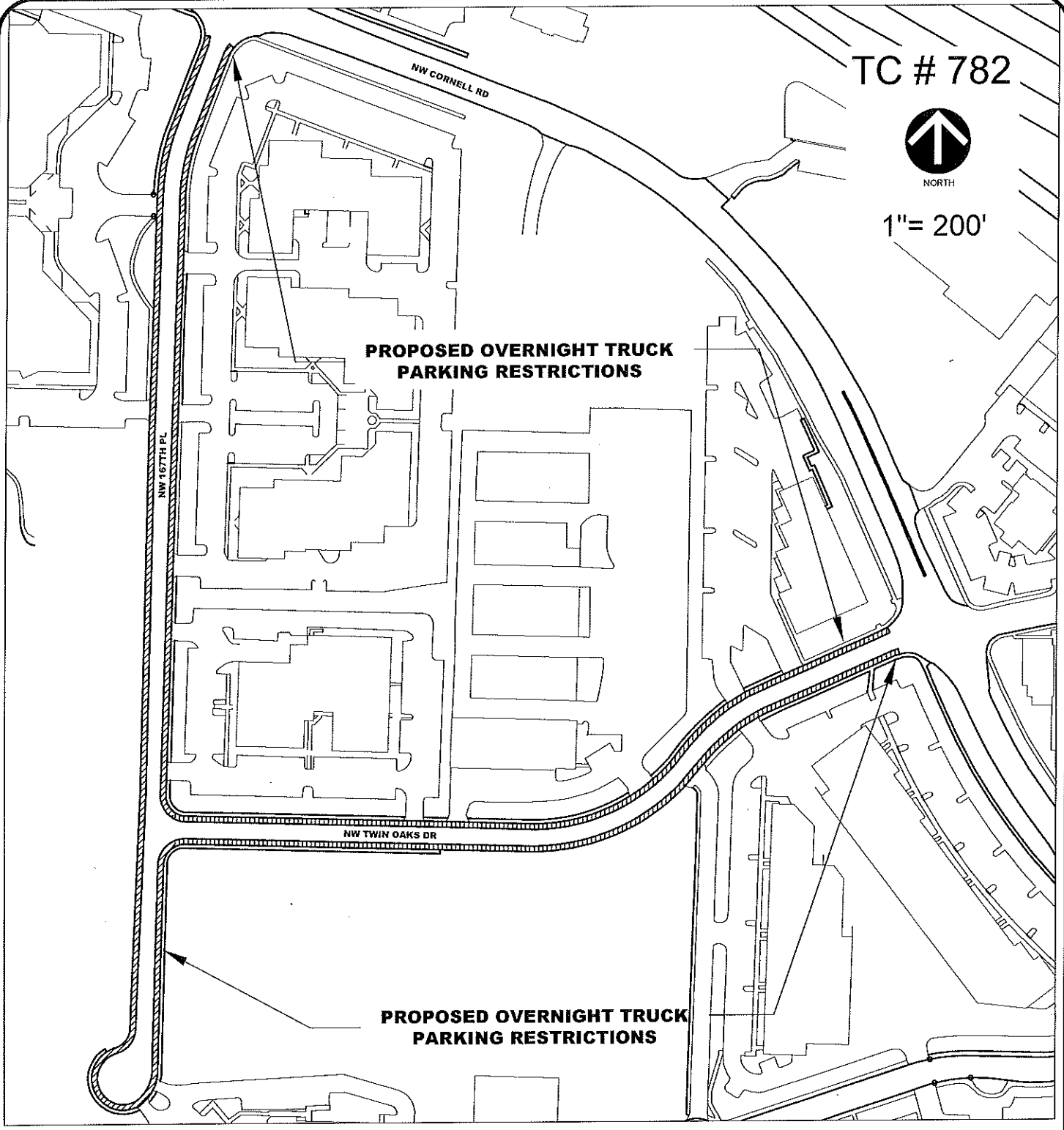

Y:\TRANSPORTATION\Drawings\2018\TC782 -167th Pl and Twin Oaks Dr Overnight Truck Parking Restrictions.DWG



Overnight Truck Parking Restrictions on
NW 167th Pl & on Twin Oaks Dr

**ENGINEERING DEPARTMENT
TRANSPORTATION DIVISION**

Drawn By: GO Date: 9/17/18
Reviewed By: _____ Date: _____
Approved By: _____ Date: _____

TC # 782



1" = 200'

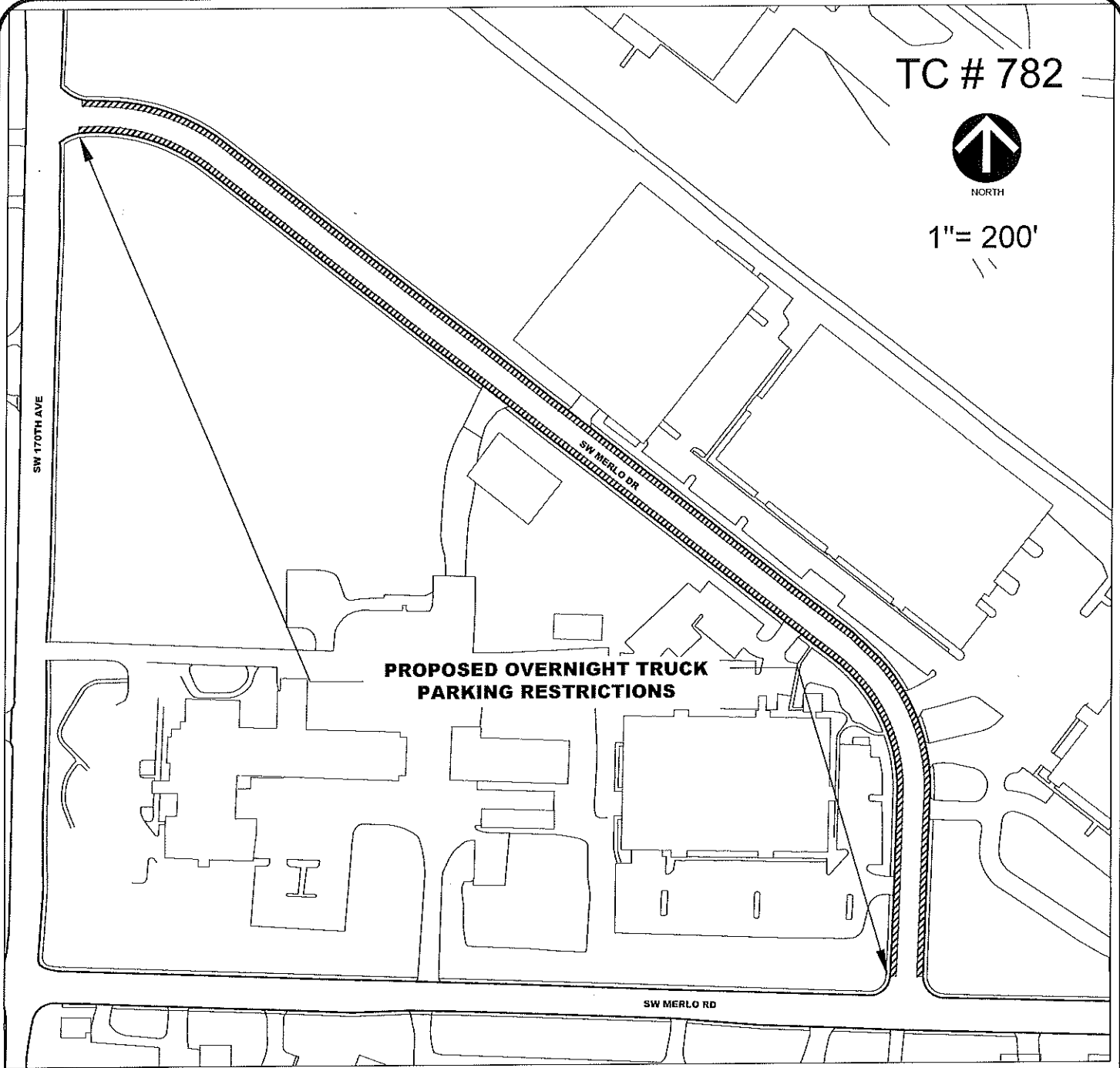

**PROPOSED OVERNIGHT TRUCK
PARKING RESTRICTIONS**

 PROPOSED OVERNIGHT TRUCK PARKING RESTRICTIONS.

Y:\TRANSPORTATION\Drawings\2018\TC782 - Merlo Road Overnight Truck Parking Restrictions.DWG



Overnight Truck Parking Restrictions on
SW Merlo Dr

**ENGINEERING DEPARTMENT
TRANSPORTATION DIVISION**

Drawn By: GO Date: 9/17/18
Reviewed By: _____ Date: _____
Approved By: _____ Date: _____

MEMORANDUM

Beaverton Police Department



DATE: August 23, 2018

TO: Jabra Khasho

FROM: Officer Mark Barrowcliff

SUBJECT: Semi Truck Parking

Jabra

I am asking if the city can look into changing the current parking regulations on several city streets with semi-trucks, box trucks and trailers. I have been working with RV's on the new city No Camping ordinance throughout the city and have noticed that there is another parking problem that needs to be addressed is the semi-truck, box trucks and trailers parking on side streets at 167th and Twin Oaks and Merlo Dr.

The semi-trucks parking on 167th and Twin Oaks and on Merlo Dr are not connected to any of the local business on these streets. Truck drivers use these areas as a place to park their semi-trucks and trailers while they are not working as a place to store them. I often see a secondary car arrive to pick up or drop off the driver of the truck to take them away.

In the past, these streets were industrial areas where parking these large semi-truck caused no harm to traffic or the community. Since the population has grown and traffic has increased in these two areas, they have become more hazardous to the community. I am asking the City to revisit the parking ordinance that allowing semi-trucks and box trucks to park at these areas.

Below is the streets and why there is a problem.

Merlo Drive.

Semi-trucks usually park on the west end of Merlo Dr near 170th. The truck usually stay anywhere from overnight to several weeks at a time. The trucks park on both sides of the road and make the narrow street even narrower for passing cars.

PD # 3045

Merlo High School is located on the same street with high school kids and staff coming and going throughout the day. The Water District and THPRD created a soccer field on the southwest corner of Merlo Dr and 170th. During the weekends, parents and kids are forced to park on Merlo Dr and walk to the park to play their sporting games.

Due to Merlo Dr being a curved street, the visibility is very short, then when semi-trucks are parked along the curbs, it makes everything more dangerous seeing and maneuvering around them walking and driving.

Condos, apartment and town homes have now circled this area all within several blocks. People walking, driving and riding bikes are now using Merlo Dr attempting to get to Tri-Met Max stop and park and ride creating even more congestion.

I spoke to the property owner on the north side of Merlo Dr, Paul Lin who owns Standard Bag Manufacturing Co. Lin said that none of the semi-truck belong to his business, and that the trucks that park on the street make it difficult for his driver to come and go from his property. Lin said that all the trucks parking on the street belong to private drivers who park on the street during various times to while they are not working.

167th and Twin Oaks Dr.

167th street is connected to the back side of 5 Oaks Middle school. Beaverton School District has purchased property and created a bus barn for storing school busses. During all times of the day school busses are coming and going down 167th. When semi-trucks park along the streets it make the passing of school bused very narrow. Business along 167th and along Twin Oaks are forced to park along the streets, creating a very narrow travel lane.

Citizens from the local business (School District, Luis Palau Church) say the semi-trucks parking on the street make it unsafe to see around when driving and when walking on the sidewalks.

Again the semi-truck parked along these streets do not belong to any of the local business. The semi-truck owners park there truck along these streets to store them for several days to weeks for storage.

I am asking the City to revisit the parking ordinance that allowing semi-truck to park at these areas. The traffic congestion in these areas and around the city have changed and it is unsafe to allow the box trucks and semi-truck to continue to park and store there trucks along the streets in these areas.

Thank you

PD # 3045

Officer Mark Barrowcliff
Beaverton Police Department



PD # 3045





PD # 3045